



©NYC DOT

AUTOMATIC PUBLIC TOILET (APT) LOCATION IN BROOKLYN COMMUNITY DISTRICT 14

JCDecaux / DOT Coordinated Street Furniture Franchise

Automatic Public Toilets (APTs)

- Franchisee installs and maintains units; capital and expense funds are not used here
- Open 8am-8pm daily
- Self-clean
- 15 minutes per use
- Fully accessible
- Maintained twice daily
- Free of charge and have a bottle filler on the side of the unit
- New APT has smaller footprint
- New APT has technology upgrades

APT Design

Unit Exterior and Specs

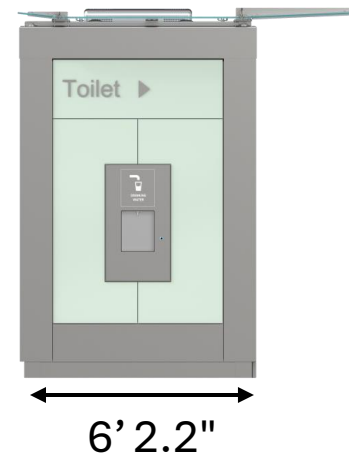
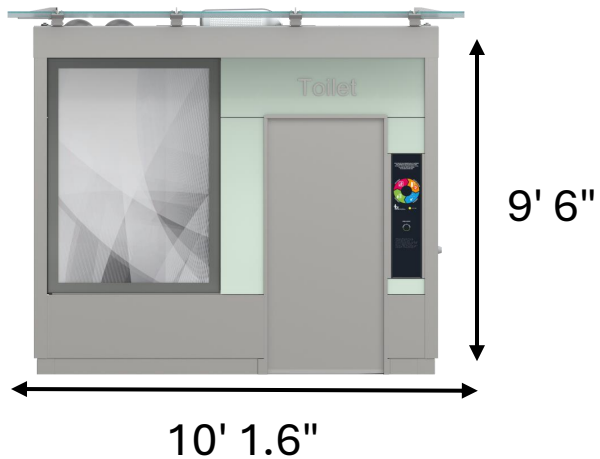

APT Site Specifications

- Street level clearances
 - 8' in the front
 - 5' on the sides
 - 3' in the back
- Underground clearance
 - 5-6' for utility and water connections.
- New pump system will allow placement in or near flood zones
- Footprint is smaller than a sedan size car

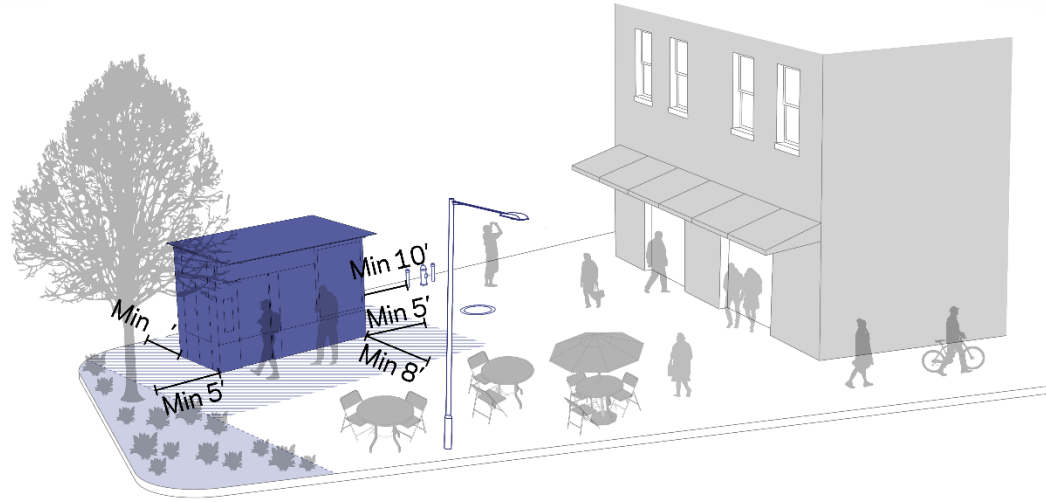

APT Approval Process

- Site passed engineering review
- NYC Parks and Prospect Park Alliance approved
- Approvals Needed
 - Community Board
 - Council Member
 - Speaker of the Council
 - Mayor
 - PDC

Location Benefits

Potential Users

- Park Goers
- Shoppers
- Joggers
- Cyclists
- Residents
- Pedestrians
- Tourists
- Children



Proposed Location – Park Circle

Focused on finding sites adjacent to Parks, greenstreets, and road triangles

On Park Circle sidewalk, near Coney Island Ave, does not disturb the historic entrance of Prospect Park

In CD 40, Community Board 14

Near NYPD station, but not in way of driveways

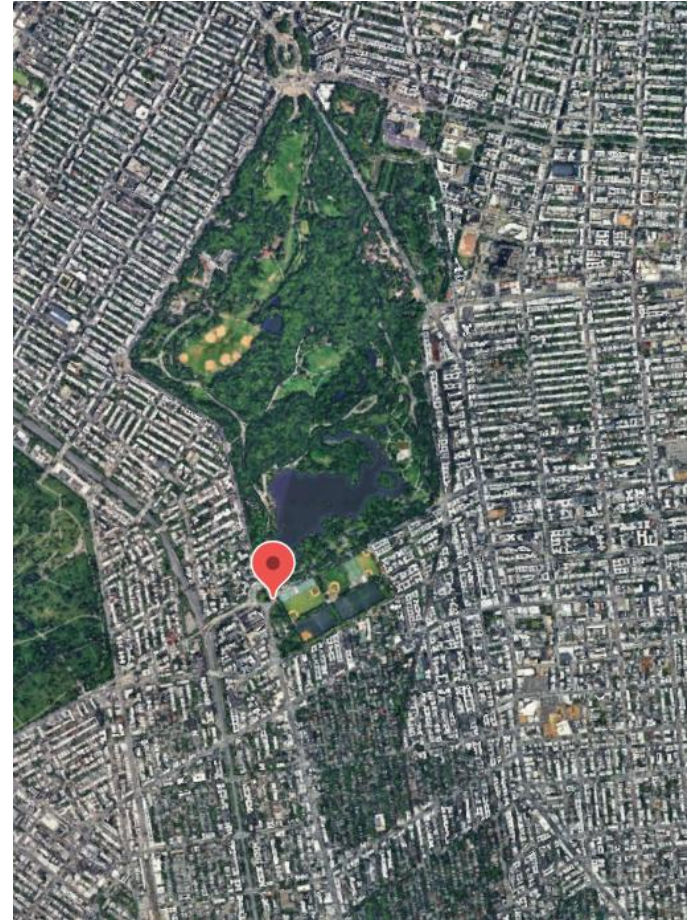

Proposed Location

Aerial View



Proposed Location

Location Overview



Proposed Location

Location Overview



Proposed Location

Location Overview



Park Circle

Placement



Park Circle

Placement

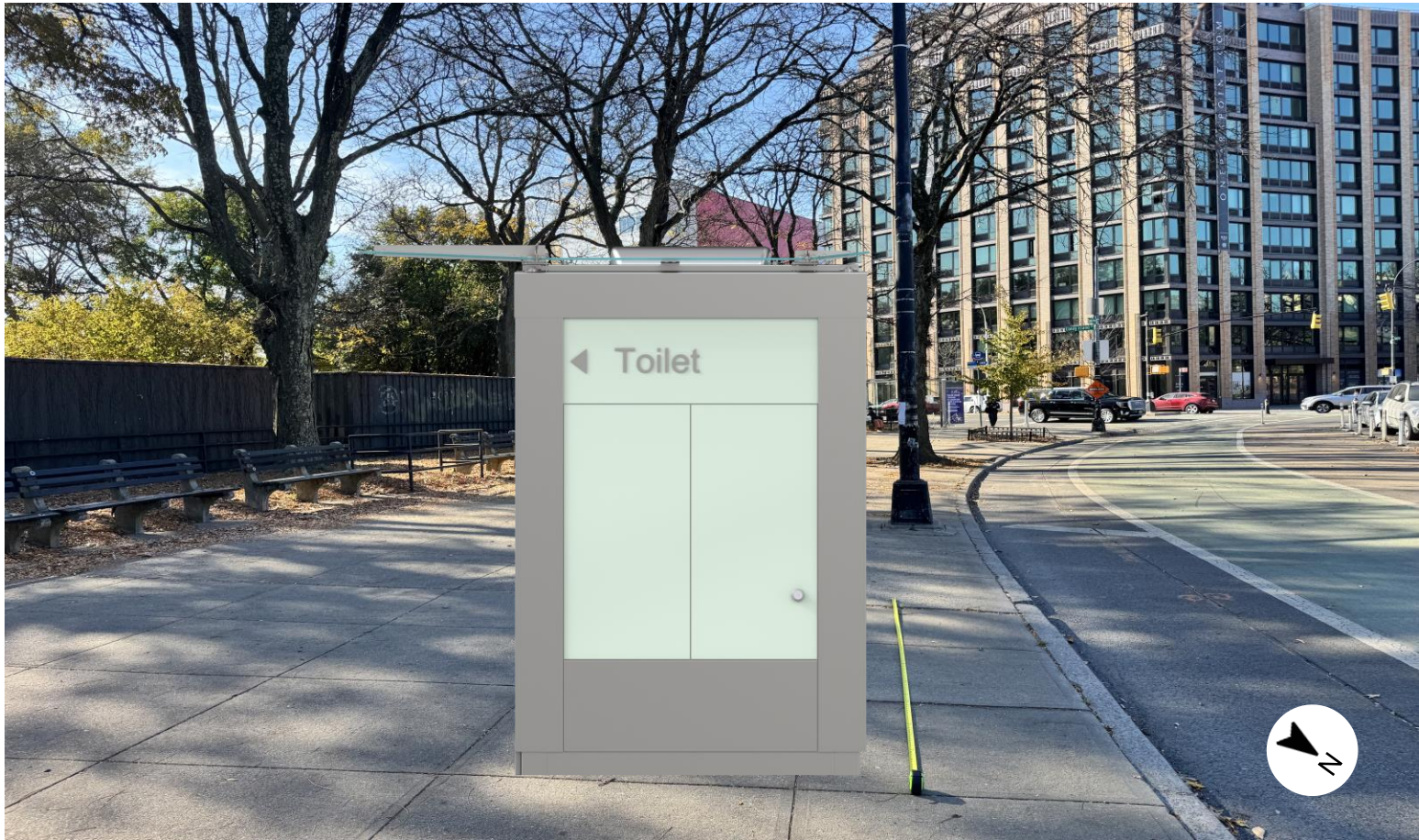

Park Circle

Placement



JCDecaux Site Plan

	BUS SHELTER
	BUS STOP SIGN
	BENCH
	CATCH BASIN
	CELLAR EXIT
	EMERGENCY SUBWAY EXIT
	FENCE/RAILING
	FIRE ALARM
	FIRE HYDRANT
	MAILBOX
	NEWS STAND
	OIL INTAKE
	PARKING METER
	PLANTING AREA
	REVOLVING DOOR
	RECEPTACLE (TRASH)
	SEWER
	STREET LIGHT
	STREET LIGHT (WITH TRAFFIC SIGNAL)
	STANDPIPE
	TELEPHONE BOOTH
	TRAFFIC CONTROL UNIT (ABOVE)
	TRAFFIC CONTROL UNIT (BELOW)
	TRAFFIC SIGNAL
	TRAFFIC SIGN
	TREE PIT
	UTILITY POLE (WITH POWER)
	VALVE (GAS OR WATER)
	VENT/GRATING
	WALK/DONT WALK

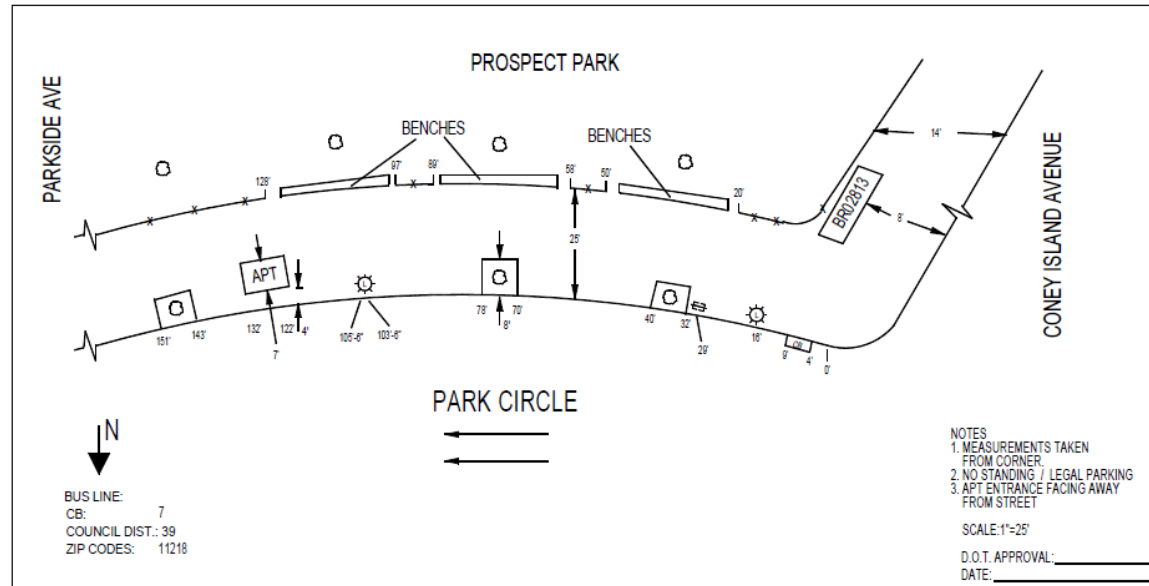

LOCATION: SE PARK CIRCLE @ PARKSIDE AVE
PLANNING NUMBER:
DRAWING BY: RS 06/03/25 NO. APT1007_060325

SENSITIVE: YES
LOCATION NEAR: COMMERCIAL / RESIDENTIAL
SIDEWALK: CONCRETE
LATITUDE: 40.65071
LONGITUDE: -73.97157

JCDecaux

350 5th Ave, 73rd floor, New York, NY 10118 Ph: 646-834-1200

THANK YOU!

Questions?



NYC DOT



NYC DOT



nyc_dot



NYC DOT